

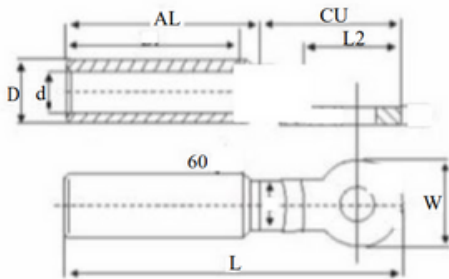

### Bi-Metal Lugs

- Material:** 99.5% pure aluminium  
99.95% pure copper
- Joint Method:** Friction Welding
- Operation Temperature:** - 40°C to 100°C
- Conformant Standards:** AS4325-1(AUS.)



Part No.	Cable Spec. (mm <sup>2</sup> )	Dimensions (mm)						
		d	D	W	L	LI	T	
LBM025	25	7.5	12	22	75	32	4.5	M8, M10
LBM035	35	8.5	12	22	75	32	4.5	M8, M10
LBM050	50	9.5	16	22	75	32	5	M10, M12
LBM070	70	11.5	16	22	75	32	5	M10, M12
LBM095	95	13.5	21.5	30	115	60	6	M10, M12
LBM120	120	15.5	21.5	30	115	60	6	M12
LBM150	150	16.5	27	35	120	60	6	M12
LBM185	185	18.5	27	35	120	60	6	M12, M16
LBM240	240	22	35	35	135	60	7	M12, M16
LBM300	300	23.5	35	35	135	60	7	M12, M16
LBM400	400	26.5	47	50	165	70	10	M12, M16
LBM500	500	30	47	50	165	70	10	M16, M20
LBM630	630	34	54	50	185	70	10	M16, M20